

Introducing the Embossing Square

The Embossing Square allows you to emboss the various motifs/patterns onto paper, aluminium or copper. Also to create 4 patterned borders, achieving a continuous embossed border design around the edges of your design, card or invitation.

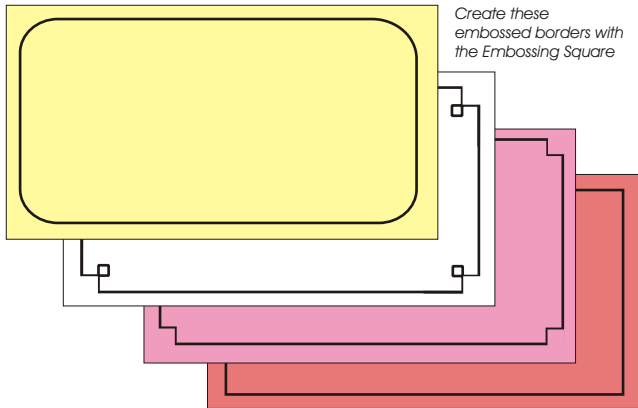
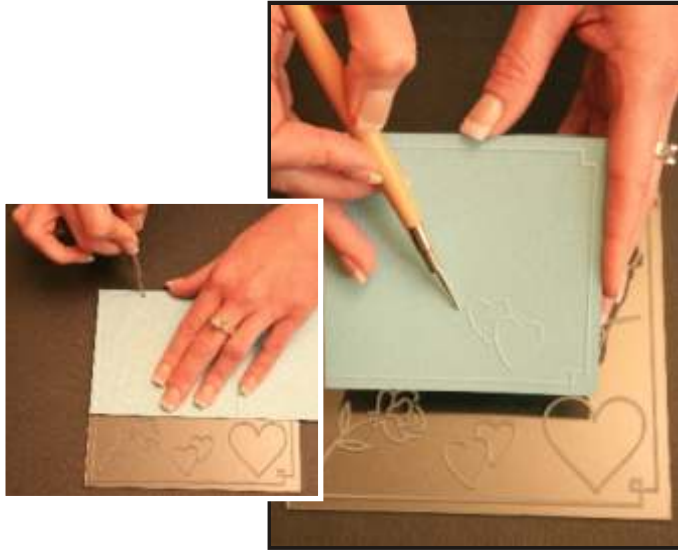

Create these embossed borders with the Embossing Square

"I love the Embossing Square because I am able to emboss beautiful borders onto my cards. It has added a whole new dimension to my card making and my customers love the effect"

Rosemary - Professional Card Maker

Easy to emboss borders



Position corner of paper onto the desired corner pattern of the Embossing Square.

Ensure the edge of paper is square / flush to the edges of the Embossing Square.



Using your hand or fix into position with tape, hold the paper in position whilst embossing.



Emboss the corner design including the straight lines either side, allowing enough length to be able to continue the embossed line into the next corner.

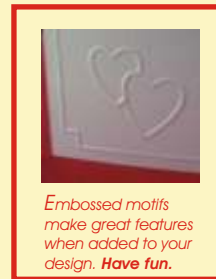

Embossed motifs make great features when added to your design. **Have fun.**



Rotate your paper and position into the same corner and continue by picking up the groove from the first line.

Continue until all edges are complete.



These products are copyright protected.

Available from:

**Paper
indulgence**

471 Victoria Street, Brunswick West 3055